

Pioneers in Quality

Introduction to Joint Commission's Sustainable Healthcare Certification Program Requirements

On Demand Webinar - CE Credit Available for 6 weeks after release
December 2023

Webinar Audio – Information & Tips

- Use your computer speakers or headphones to listen
 - Feedback or dropped audio are common for streaming video. Refresh your screen if this occurs.
 - You can pause the play back at any time.
 - You can return and replay the video by using the same access link from your registration email
 - Recording is captioned
 - Slides are designed to follow Americans with Disabilities Act rules
-



Slides are available now!

To access slides in the viewing platform:

- click icon that looks like a document
- select file name and document will open in a new window
- print or download the slides

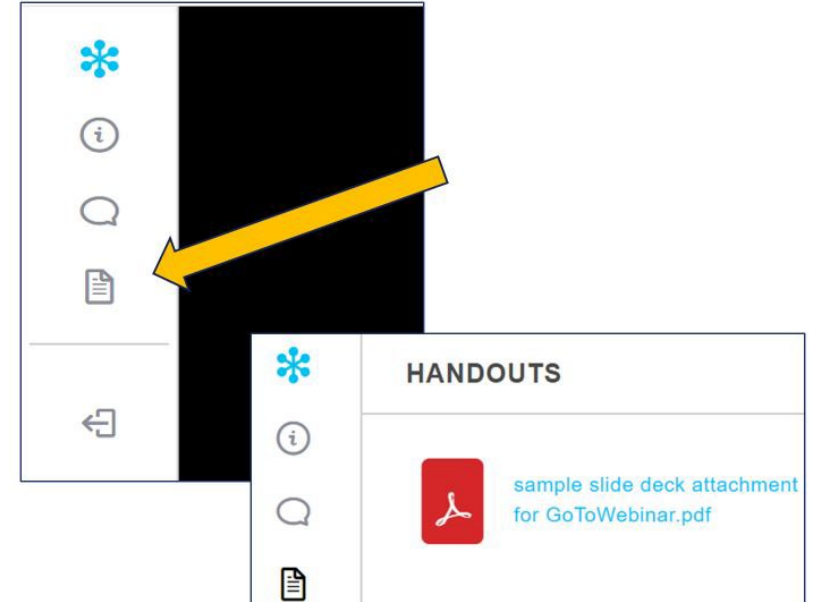

After CE period expires, slides will remain accessible on this page:

<https://www.jointcommission.org/measurement/quality-measurement-webinars-and-videos/pioneers-in-quality-general-sessions/>



Webinar is approved for 1 Continuing Education (CE) Credit for:

- Accreditation Council for Continuing Medical Education
- American Nurses Credentialing Center
- American College of Healthcare Executives
- California Board of Registered Nursing
- International Association for Continuing Education Training (.1 credit)

Continuing Education credits are available for this On Demand webinar for 6 weeks following its release date.



To earn CE credit, you must:

- 1) Individually register for this recorded webinar.
- 2) Participate for the entire recorded webinar.
- 3) Complete a short reading activity.
- 4) Complete a post-program evaluation/attestation survey.

For more information on The Joint Commission's continuing education policies, visit this link
<https://www.jointcommission.org/performance-improvement/joint-commission/continuing-education-credit-information/>

To obtain your CE Certificate



- Evaluation/attestation survey QR code displayed at end of webinar.
 - Evaluation/attestation survey link displayed in pop-up after recording ends. Cut and paste link into your browser; ***link is not clickable.***
 - Survey link also provided via follow-up email after you finish the recording.
 - **Complete the online evaluation survey.**
 - After you click ***SUBMIT***, you will be redirected to a URL from which you can print or download/save your PDF CE Certificate.
 - A follow-up email from the survey platform also provides the link to the CE certificate.
-

Learning Objectives



- Describe the Sustainable Healthcare Certification program requirements and the rationale for each
 - Locate and use available resources
-

Disclosure Statement

These staff and speakers have disclosed that they do not have any conflicts of interest. For example, financial arrangements, affiliations with, or ownership of organizations that provide grants, consultancies, honoraria, travel, or other benefits that would impact the presentation of today's webinar content.

- Susan Funk, MPH, LSSGB, Associate Project Director, Engagement in Quality Improvement Programs, The Joint Commission
 - Phavinee Thongkhong Park, RN, PhD, Associate Director, Department of Standards and Survey Methods, The Joint Commission
 - Kathryn Petrovic, MSN, RN, Director, Department of Standards and Survey Methods, The Joint Commission
 - Brette Tschurtz, MPH, Associate Director, Department of Research, The Joint Commission
-

Welcome & Introduction

Speakers



Kathryn Petrovic, MSN, RN
Director - Department of
Standards and Survey Methods
Email:
KPetrovic@jointcommission.org



Phavinee Thongkhong Park, RN, PhD
Associate Director - Department
of Standards and Survey Methods
Email:
PThongkhong-
Park@jointcommission.org



Brette Tschurtz, MPH
Associate Director - Department
of Research
Email:
btschurtz@jointcommission.org

“In healthcare, we are united in the mission toward doing good for all people. As an unintended consequence of our work, however, we are contributing disproportionately to climate change”

Jonathan B. Perlin, MD, PhD, MSHA, MACP, FACMI
President and CEO
The Joint Commission

Environmental Sustainability Importance



Nearly 9% of the U.S. carbon footprint is from healthcare

Impacts on health contributing to chronic diseases,
acute illness

Environmental sustainability can improve patient care,
strengthen workforce engagement, and provide financial
savings

Sustainable Healthcare Certification (SHC)

Certification Program for hospitals/critical access hospitals (HAP/CAH)

- Available to TJC-accredited or compliant with applicable federal laws, including applicable Medicare CoPs
- Awarded at **organization level** (HCO #) for 2 years
- **Provides a framework** to expand or continue organization's decarbonization efforts
- **Provides public recognition** for their commitment and achievements in contributing to environmental sustainability
- Voluntary certification launches **January 2024**



SHC Certification Requirements

Sustainable Healthcare Certification Domains

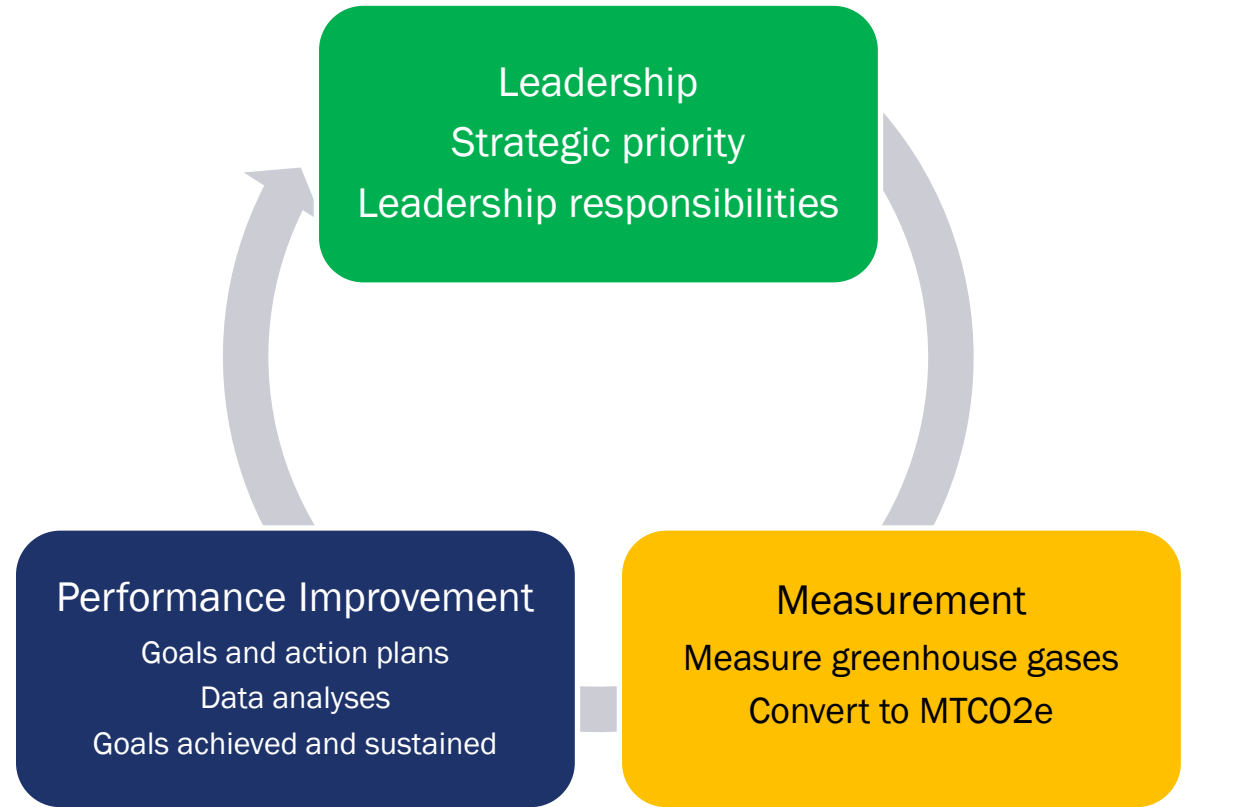

Leadership Requirements

SHCLD.01 Environmental sustainability is a strategic priority.

Intent: Leadership and governing commitment are essential for successful initiatives within an organization.

Implementation strategies:

- Form an executive-level sustainability committee or team
 - Strategic planning and plan
 - Goals and specific outcomes
 - Organizational plan and tactics
 - Resource allocation
-

Leadership Requirements

SHCLD.02 The organization defines leadership responsibilities

Intent: Appoint leader(s) responsible for oversight and coordination of greenhouse gas reduction activities

Implementation strategies:

- Develop and implement operational plan
 - Goals and objectives
 - Key stakeholders from departments or focus areas
 - Concrete and actionable steps
-

SHC Measurement of Six GHG Emission sources

- Energy use
- Purchased energy
- Anesthetic gas use
- Fleet emissions
- Pressure metered-dose inhalers (PMDI)
- Waste disposal

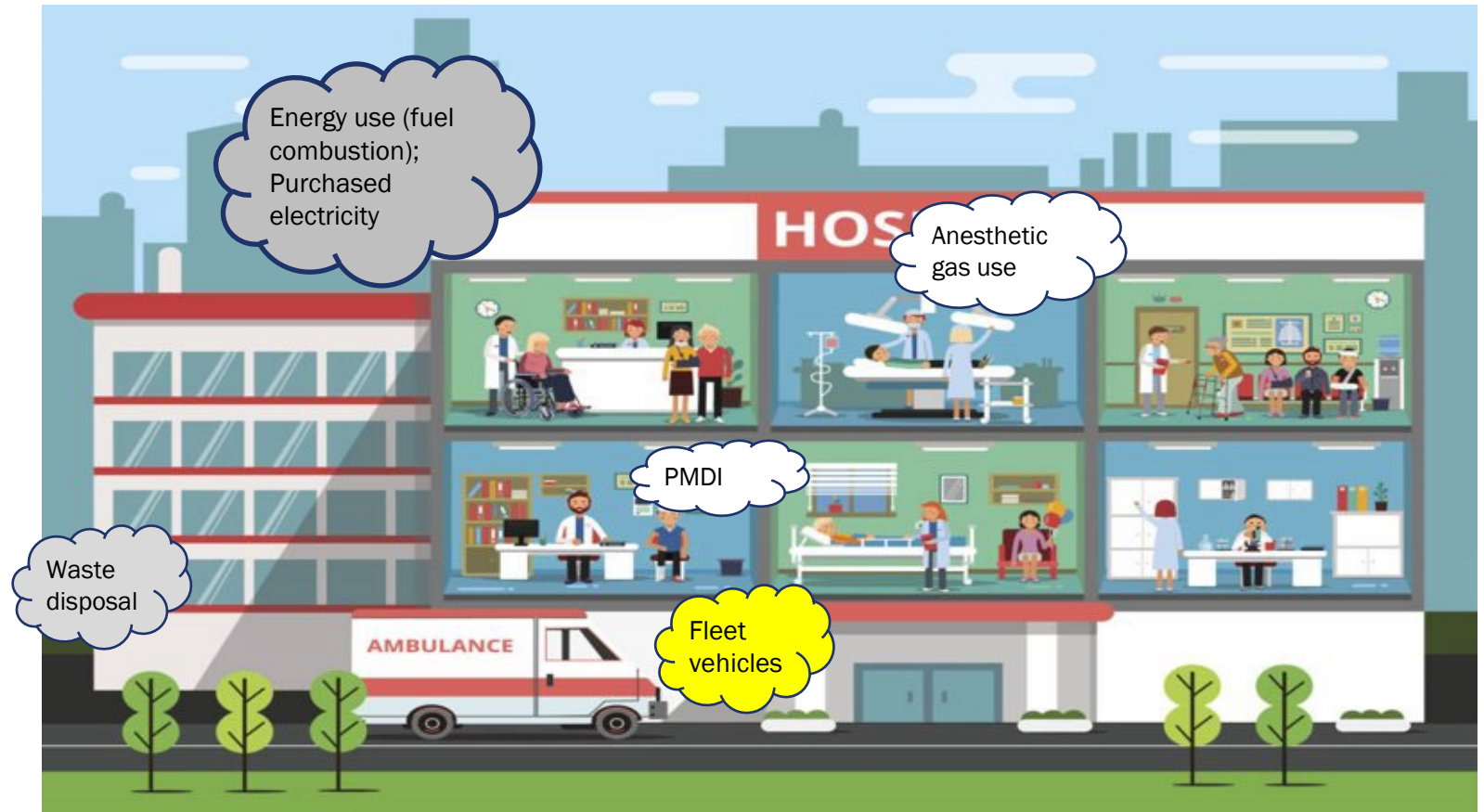

Measurement Requirements

SHCME.01 The organization measures its greenhouse gas (GHG) emissions.

Intent: The organization takes actions to start their journey towards decarbonization by measuring activities that contribute to greenhouse gas emissions. MTCO₂e is a standard unit of comparison for the different types of GHG emissions.

Implementation strategies:

- Prepare a GHG emissions inventory
 - Identify the data sources for the 6 GHG emission sources
 - Enter the data into a tool and convert to metric tons of carbon dioxide equivalents
-

Energy Use and Purchased Electricity, Steam, or Heating and Cooling

Energy Use

Implementation strategies:

- Calculations based on the quantities of purchased fuels
- Collect data and information about the type of fuel used and the quantity of fuel combusted at each facility.
- Data are often provided by the utility company (monthly natural gas bill)

Purchased electricity, steam, or heat/cooling

Implementation strategies:

- Collect electricity purchase data in units of kWh for each facility
 - Best data source is the electricity bill or invoice
 - Determine the amount of steam purchased or heat (district hot water)
-

Measurement: Anesthetic Gas Use and Pressurized –Metered Dose Inhalers

Anesthetic gas use

Implementation strategies:

- Evaluate anesthetic choices at your organization by tracking procured anesthetic drugs
- Examine infrastructure leaks with piped nitrous oxide; consider use of portable E cylinders

Pressurized-metered dose inhalers

Implementation strategies:

- Measure pressurized-metered dose inhaler prescribing practices
- Consider opportunities to shift to lower carbon alternatives

Measurement: Fleet Vehicle Carbon-based Fuel Use and Waste Disposal

Fleet vehicle carbon-based fuel use

Implementation strategies:

- Examine fuel usage by organization owned vehicles
- Determine the types of vehicles, types and amounts of fuel, and miles driven for each vehicle of vehicle type in the fleet

Waste disposal

Implementation strategies:

- Collect data on the amount of waste weight disposed of at your organization
 - Include the type of waste (plastics, paper, etc.) and the disposal method (recycling, incineration, etc.)
-

Resources for Implementation

Greenhouse Gas Protocol

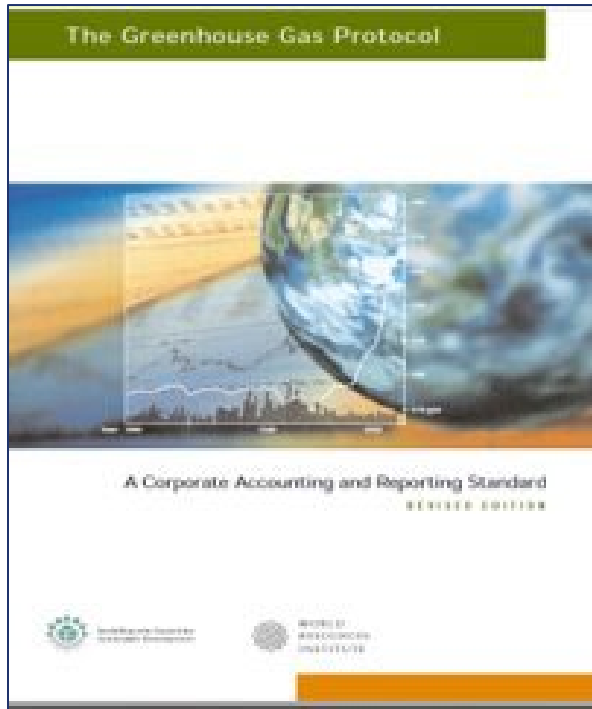

AHRQ Primer: Reducing Healthcare Carbon Emissions (2022)

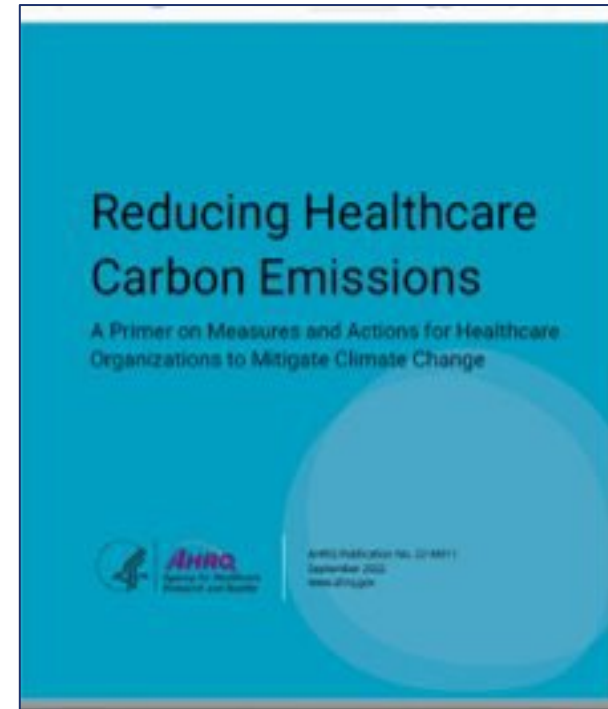

Performance Improvement Requirements

SHCPI.01 The organization improves its environmental footprint by reducing its greenhouse gas emissions.

Intent: Written goals and action plans are needed to support the reduction of GHG emissions. Data collection, analysis, and reporting are important to tracking progress towards the organization's GHG goals.

Implementation strategies:

- Apply the cycle for performance improvement to identify improvement opportunities; start by collecting data to establish a baseline
 - Develop and implement a plan, display, and share measurement results in areas measured (i.e. energy use, anesthetic gas use, waste disposal, etc.)
 - Review effectiveness of interventions implemented as evidenced by reductions in identified emission sources
-

Review Process

Review Process

Overview

- 1 Day
- 1 Reviewer
- Off-site review Microsoft Teams
- Documentation upload prior to review not required
- Organizational review (HCO#)



Review Process (2)

Pre-review

- Sustainable Healthcare standards and Review Process Guide
 - **Initial** review – 30 day notice
 - **Recertification** – 7 day notice
 - Internet connection and hardware confirmation
-

Review Process

Review activities

Time	Activity
30 minutes	Opening Conference
60 minutes	Reviewer Planning Session
60 minutes	Orientation to the Organization's Environmental Sustainability Program

Review Process

Review activities (continued)

Time	Activity
90 minutes	Measurement of Greenhouse Gases
60 minutes	Performance Improvement
30 minutes	Summary Discussion

Review Process

Review activities (continued)

Time	Activity
60 minutes	Reviewer Report Preparation
30 minutes	Organization Exit Conference

Resource Center

Sustainable Healthcare Resource Center

Hospitals consume energy and use materials that contribute to increased waste and greenhouse gas emissions. Estimates suggest that the healthcare industry accounts for approximately 8.5 percent of national carbon emissions. It is important that health care does its part to help improve its environmental footprint.



Sustainable Healthcare Resource Center



Questions?

Regarding the standards and elements of performance content, use this form: dssminquiries.jointcommission.org

The pre-publication standards are available online:

https://www.jointcommission.org/-/media/tjc/documents/standards/prepublications/2024/shc_prepub_jan2024-final-2.pdf

Regarding the On Demand webinar operations and CE inquiries: pioneersinquality@jointcommission.org

Pioneers in Quality Webinar Series

To access previous recording links, slides, and Q&A documents visit the Pioneers in Quality Webinars landing page:

<https://www.jointcommission.org/measurement/quality-measurement-webinars-and-videos/pioneers-in-quality-general-sessions/>

Pioneers in Quality General Sessions

The Joint Commission's Pioneers in Quality General Sessions provide information such as measurement requirements, changes in reporting, opportunities for engagement and/or recognition, and insights regarding data analysis of national clinical quality measurement data received. This generalized content is meant as education for hospitals and health systems to assist them in meeting current and future requirements.

As Joint Commission schedules the Pioneers in Quality General Sessions, check back for updates.

Pioneers in Quality General Sessions

<input type="checkbox"/> Recent	10
<input type="checkbox"/> Past	1

Results 1-10 of 17

DATE PUBLISHED ▾

RESOURCE

[Click Here to Register and View - New and Revised Requirements for Joint Commission's Stroke Certification Programs](#)

10/20/2023
[Slides](#) | [Transcript](#)

RESOURCE

[Click here to Register: Pioneers in Quality Webinar-2024 Joint Commission ORYX Performance Measurement Requirements](#)

09/05/2023

RESOURCE

[Click Here to Register and View - On Demand Webinar: Introduction to New Assisted Living Community Memory Care Certification Requirements](#)

07/25/2023
[Slides](#) | [Transcript](#)

Webinar CE Evaluation Survey



1. Use your mobile device to scan the QR code.
2. A pop up at the end of this recording includes link to the evaluation survey. **Copy/paste link into your browser.**
3. An automated email sent after you finish the recording also directs you to the evaluation survey.

CEs are available for 6 weeks only. Promptly complete the survey.



CE Certificate Distribution

After you complete the online evaluation survey, click SUBMIT. You will be redirected to a url from which you can print or download/save a PDF CE Certificate.

Thank you for attending!



**Access the CE Survey
using this QR code!**



pioneersinquality@jointcommission.org



<https://www.jointcommission.org/measurement/quality-measurement-webinars-and-videos/pioneers-in-quality-general-sessions/>

The Joint Commission (TJC) Disclaimer

- These slides are current as of **10/11/2023**. The Joint Commission and the original presenters reserve the right to change the content of the information, as appropriate.
- These will only be available until **12/31/2024**. At that point, The Joint Commission reserves the right to review and retire content that is not current, has been made redundant, or has technical issues.
- *These slides are only meant to be cue points, which were expounded upon verbally by the original presenter and are not meant to be comprehensive statements of standards interpretation or represent all the content of the presentation. Thus, care should be exercised in interpreting Joint Commission requirements based solely on the content of these slides.*
- These slides are copyrighted and may not be further used, shared, or distributed without permission of the original presenter and The Joint Commission.
- **The Joint Commission nor the presenter endorses or promotes any company's products or services.**